

Features

- Modular relief valves limit the maximum pressure in a circuit or for over pressure protection.
- Modular design allows stacking of other modules to create custom circuits to improve the system design,
- Modular valves are flexible, easy to replace and maintain without the cost of custom manifolds.

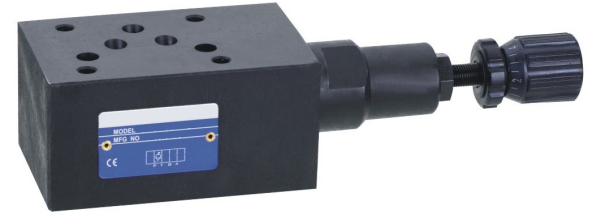

Ordering Details

V	Valve			
M	Modular			
R	Type: R = Relief			
6-	Mounting Size			
P-	Circuit Function			
R-	Adjustment Type: H = Allen Wrench, R=Rotary Knob			
30-	Maximum Pressure Setting			
1	Series			

Code	Size
6	NG6 (D03)
10	NG10 (D05)
16	NG16 (D07)
25	NG22/25 (D08)

Code	Pressure Adjustment Range PSI	Mounting Size
10	101.5 - 1015	6, 10, 16, 22
30	1015 - 3045	6, 10
36	1015-3625	16, 22

Code	Symbol
P	
A	
B	
AB*	

*Not available on size 16 and 22

Example Part Number: VMR-6-P-R-30-1

Technical data

Size	Max. Flow lpm (gpm)	Max. Pressure, bar (psi)	Min. Flow lpm (gpm)	Weight Kg (lbs.) P, A and B Circuit	Weight Kg (lbs.) AB Circuit	Fluid Recommendation	Working temperature	Oil Cleanliness
VMR-6	35 (9)	210 (3045)	5 (1.3)	1.2 (2.6)	1.4 (3.1)	Mineral Based, viscosity 2.8- 500mm ² /s	-30 to +80°C (-4 to +176°F)	According to ISO4406 Class 20/18/15
VMR-10	70 (18)	210 (3045)	5 (1.3)	2.7 (5.9)	3.1 (6.8)			
VMR-16	200 (52)	250 (3625)	14 (3.6)	6 (13.2)	-			
VMR-25	450 (118)	250 (3625)	31.5 (8.3)	12.2 (26.8)	-			

Dimensional Data, VMR (Dimensions in mm)

VMR-6-P/B

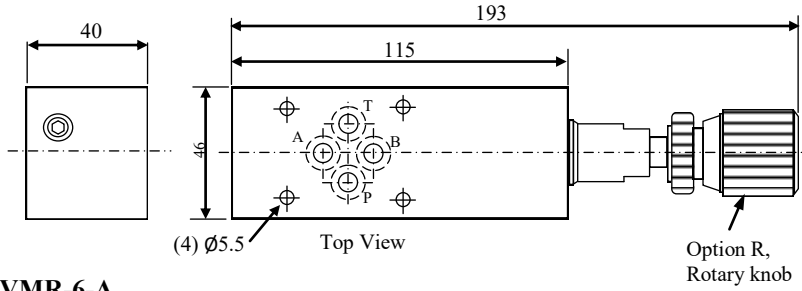

NG6/D03 Mounting Dimensions of mating surface

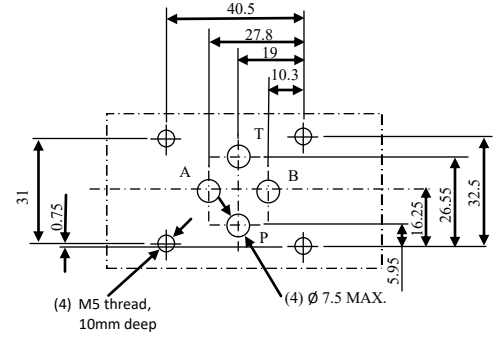

VMR-6-A

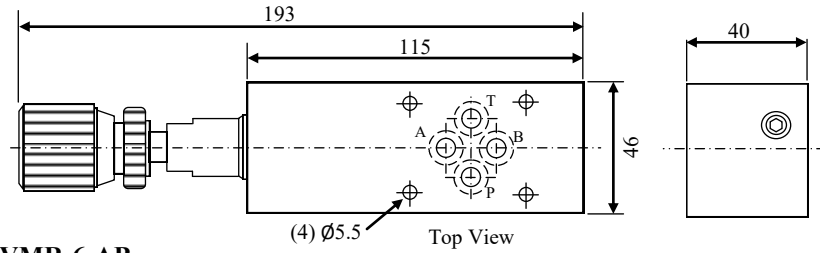

VMR-6-AB

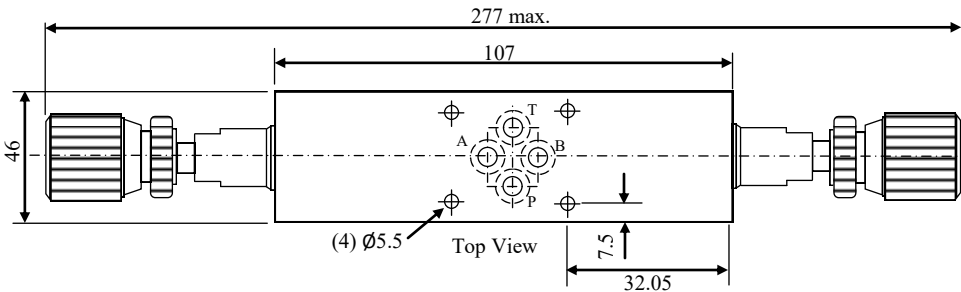

VMR-10-P/B

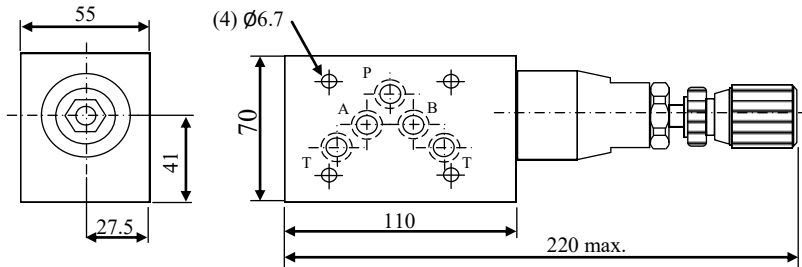

NG10/D05 Mounting Dimensions of mating surface

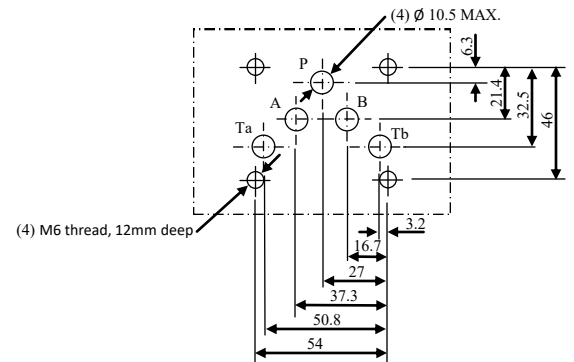

VMR-10-A

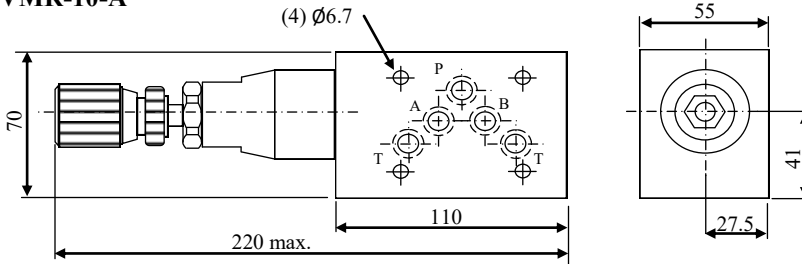

VMR-10-AB

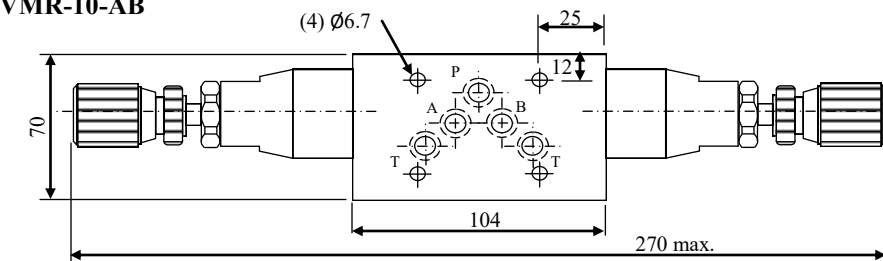

Note : Mating Surface Requirement

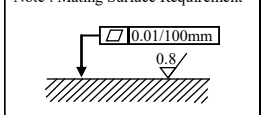

Dimensional Data, VMR (Dimensions in mm)

VMR-16-P/A

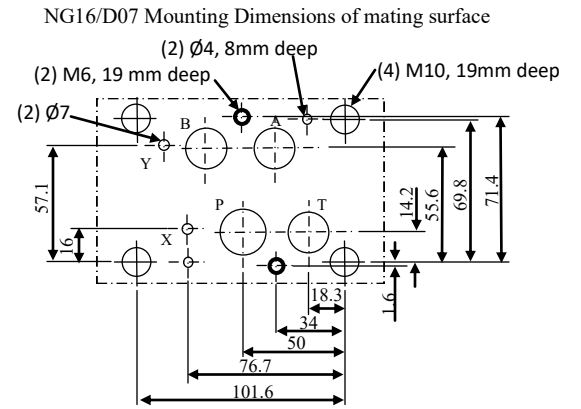
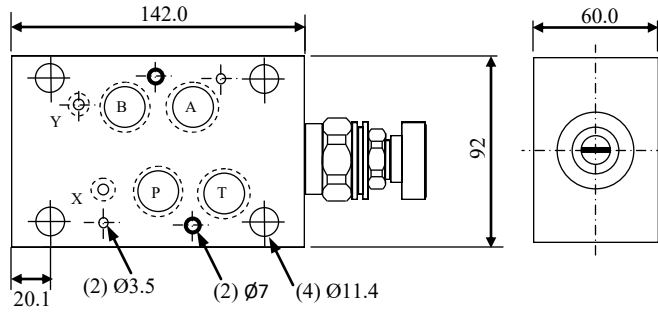

VMR-16-B

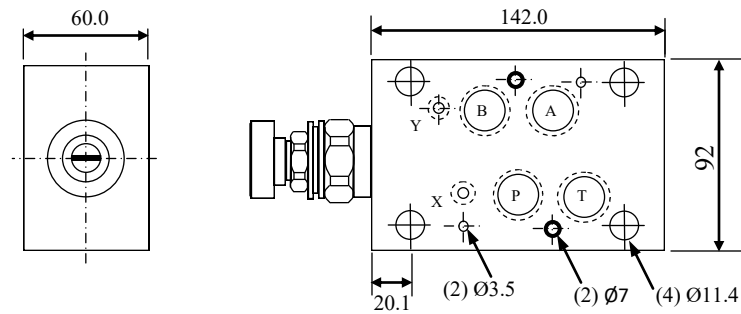

VMR-25-P/A

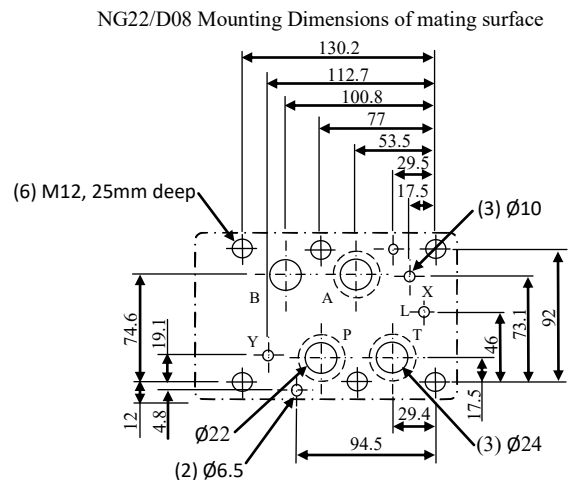
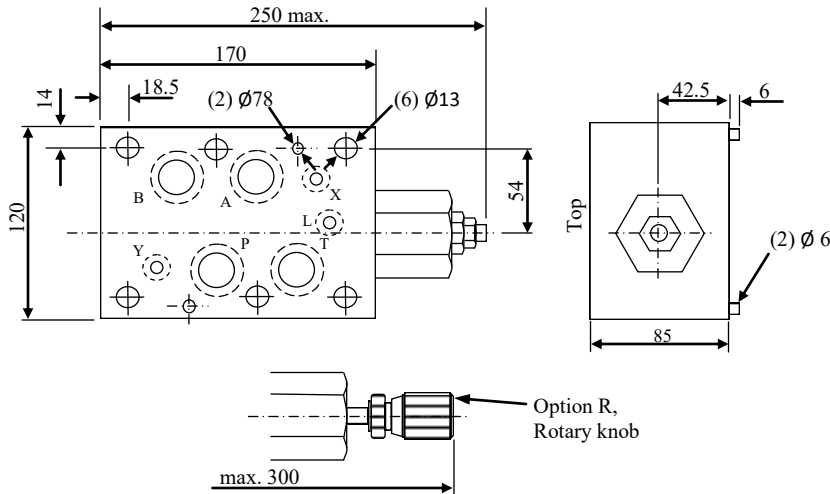

VMR-25-B

